

# Vianti Falls



Vianti Falls Spillway Kits turn any block wall into a relaxing display with the sight and sound of cascading water.

Stainless steel spillways create a soothing sheet of water and pouring scuppers are tasteful accents to any feature's focal point. Vianti Falls Spillways by EasyPro® are a stylish highlight for any patio, entryway or stand-alone feature.



[www.easypro.com](http://www.easypro.com)





# SPILLWAYS

*Viantifalls*

Internal baffles create a smooth sheet of water that cascades to the pool or basin below. The open flow design prevents clogging from debris or hard water.

Add more drama and beauty to the spillway by illuminating it with LED strip lighting.

High-quality 304 stainless steel construction resists unsightly corrosion.

Ideal for formal designs or features, signs and swimming pool features.



# WALL SCUPPERS

*Viantifalls*

Vianti Falls Wall Scuppers are perfect as stand-alone features or as a tasteful accent in any formal water feature. Choose from high quality 304 stainless steel or solid brass to suit your project.

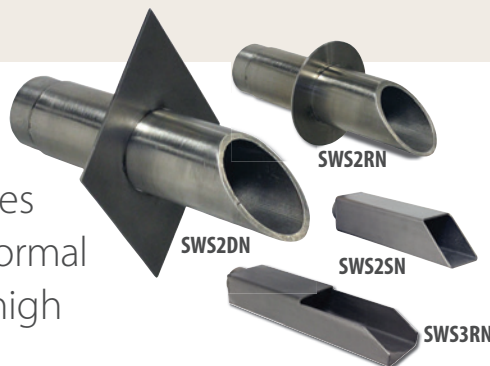

### Stainless Steel Scuppers

- 1" fpt inlet
- 5-10 gpm recommended flow rate
- Electropolished for extra protection in pools and other chlorinated systems.

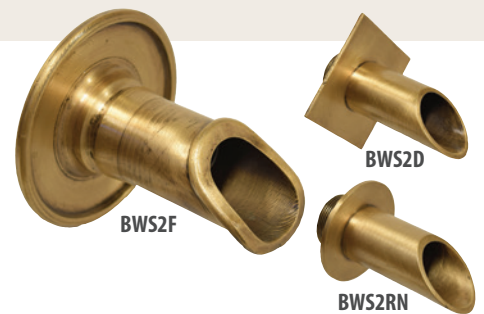

### Antique Brass Scuppers

- 1.5" fpt inlet
- Recommended flow rates:
  - BWS2F: 10-20 gpm
  - BWS2D & BWS2RN: 5-15 gpm

*Viantifalls*



Vianti Falls Spillways and Stainless Scuppers are proudly made in the USA.



11" Spillway Kit with Rectangle Basin

# KITS & MORE

## Vianti Falls

### VIANTI FALLS KITS

#### Stainless Steel Spillway

- Choose from 11", 23" or 35" spillway kits
- Available in 2" or extended 6" lips, these spillways are designed to fit into the block wall of your choice

#### Pump

- Energy Efficient EasyPro® 850, 1350 or 2200 gph mag drive pump
- Three year limited warranty

#### Plumbing

- All kits include flexible PVC pipe and fittings to connect pump and spillway

#### Basin

- Half-round basin 48"x24"x15.5" tall
- Rectangle basin: 23"x22"x13.5" tall
- High strength molded plastic
- Includes splash mat and pump access cover

#### Lighting

- LED strip lights available in cool blue, soft white or multi-colored Cabrio lighting (see below)

#### Auto-fill Valve Available

- Brass float switch-style auto-fill valve suggested



23" Spillway Kit with Half-round Basin



## VIANTI FALLS EXTENDED 15" LIP SPILLWAYS

Ideal for windy locations. Extends the waterfall out and away from the wall. Available in 35½", 47½", 59½" and 71½" widths

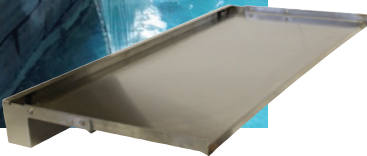

## LIGHTING *cabrio*

#### Underwater LED light strips

Add optional lighting for a stunning night time display! Choose from warm white, blue or step it up even more with Cabrio Underwater LED Light Strips.

All are available in 11", 23" and 35" lengths. Use in pairs for longer spillways.



# SPECIFICATIONS

## Viantifalls

### SPILLWAYS

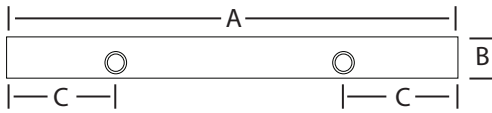
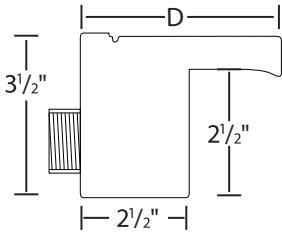
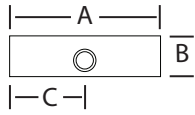

Spillway	Spillway Width	Spillway Lip Style	1" fpt Inlet (s)	Recommended Flow (gph)	A	B	C	D
<b>SSS11</b>	11.5"	2" Lip	Single	600	11.5"	3.5"	5.75"	4.5"
<b>SSS23</b>	23.5"	2" Lip	Single	1200	23.5"	3.5"	11.75"	4.5"
<b>SSS35</b>	35.5"	2" Lip	Dual	1800	35.5"	3.5"	9"	4.5"
<b>SSS47</b>	47.5"	2" Lip	Dual	2400	47.5"	3.5"	12"	4.5"
<b>SSS59</b>	59.5"	2" Lip	Triple	3000	59.5"	3.5"	12"	4.5"
<b>SSS71</b>	71.5"	2" Lip	Triple	3600	71.5"	3.5"	12"	4.5"
<b>SSS611</b>	11.5"	6" Lip	Single	600	11.5"	3.5"	5.75"	8.5"
<b>SSS623</b>	23.5"	6" Lip	Single	1200	23.5"	3.5"	11.75"	8.5"
<b>SSS635</b>	35.5"	6" Lip	Dual	1800	35.5"	3.5"	9"	8.5"
<b>SSS647</b>	47.5"	6" Lip	Dual	2400	47.5"	3.5"	12"	8.5"
<b>SSS659</b>	59.5"	6" Lip	Triple	3000	59.5"	3.5"	12"	8.5"
<b>SSS671</b>	71.5"	6" Lip	Triple	3600	71.5"	3.5"	12"	8.5"
<b>SSS1535</b>	35.5"	15" Lip	Dual	1800-2700	35.5"	3.5"	9"	17.5"
<b>SSS1547</b>	47.5"	15" Lip	Dual	2400-3600	47.5"	3.5"	12"	17.5"
<b>SSS1559</b>	59.5"	15" Lip	Triple	3000-4500	59.5"	3.5"	12"	17.5"
<b>SSS1571</b>	71.5"	15" Lip	Triple	3600-5400	71.5"	3.5"	12"	17.5"

### SCUPPERS

#### STAINLESS STEEL

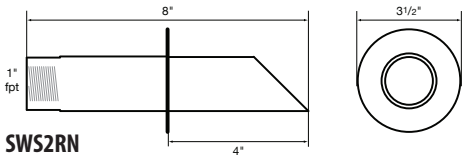

**SWS2RN**

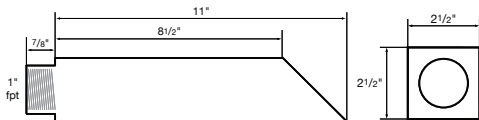

**SWS2SN**

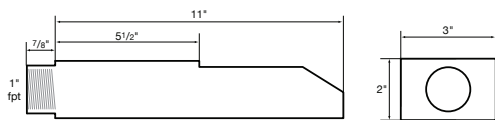

**SWS3RN**

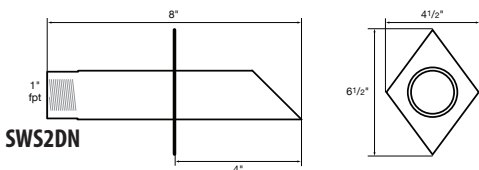

**SWS2DN**

Scupper	Shape	Metal	Inlet	Recommended Flow (gph)
<b>SWS2RN</b>	2" Round w/ round trim plate	Stainless Steel	1" fpt	5-10
<b>SWS2SN</b>	Square	Stainless Steel	1" fpt	5-10
<b>SWS3RN</b>	Channel/Rectangle	Stainless Steel	1" fpt	5-10
<b>SWS2DN</b>	Round w/ diamond trim plate	Stainless Steel	1" fpt	5-10
<b>BWS2F</b>	Antique round w/ round trim plate	Antique Brass	1.5" fpt	10-20
<b>BWS2RN</b>	Round w/ round trim plate	Antique Brass	1.5" fpt	5-15
<b>BWS2D</b>	Round w/ diamond trim plate	Antique Brass	1.5" fpt	5-15

NOTE: Drawings are not to scale.

#### ANTIQUE BRASS

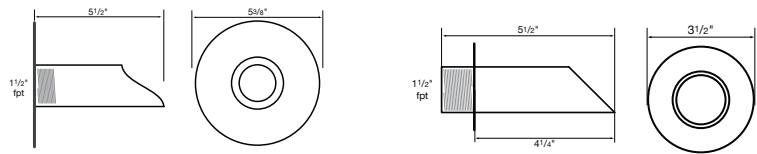

**BWS2F**

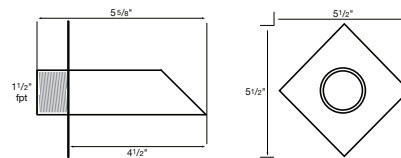

**BWS2D**