



4" Bottom Drain

Installation Instructions for EBD4A

Thank you for purchasing an EasyPro Bottom Drain. Following are a few simple instructions to help you during the installation process.

EBD4A - 4" Bottom Drain with Air Diffuser

Items included:

- EasyPro EBD4A bottom drain (Base, ring and lid)
- $\frac{3}{4}$ " x $2\frac{1}{2}$ " long check valve (blue)
- 16 stainless steel screws (12 x 1" phillips pan head)
- Membrane air diffuser (CMD3)
- 8" PVC stand pipe ($\frac{3}{4}$ " mpt)
- $\frac{3}{4}$ " mpt x $\frac{1}{2}$ " barbed elbow (for airline)

Before installation please check to insure you have all the listed parts, if anything is missing call EasyPro customer service at 800-448-3873.

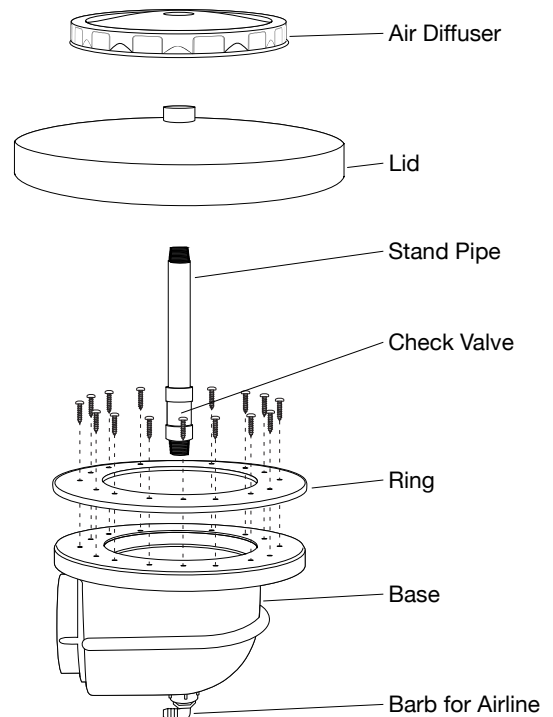

1 Drain base is installed under the liner, usually in the deepest part of the pond. Determine placement and excavate. Bottom drain and plumbing use a PVC 4" male adapter or reducing adapter to connect to PVC pipe (not included). Teflon tape threads of male adapter and tighten securely to prevent leaking. Connect 1/2" tubing to barbed elbow (installed) and clamp securely prior to glueing bottom drain to PVC pipe. Failure to clamp securely could result in leaking. Extend tubing out beyond edge of liner to be connected to air pump. Be sure air compressor sits higher than water level in pond after tubing is connected. Recommended air flow is 0.5 - 1.5 cfm.

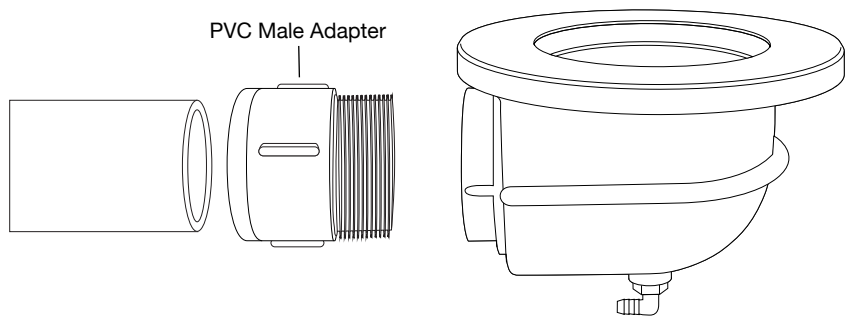

2 After installing liner, find drain base. Carefully cut an 8" hole in the liner directly above center hole in drain base. Be sure not to cut the hole larger than the center hole in the drain base. Lift the liner up a few inches and inspect the top flange of the drain base. Remove any sand or debris that may have gotten on the flange when pulling the liner into place. Place a thick bead of silicone around the middle of the flange on base and then lower liner. Be sure underlayment fabric is cut back so it **does not** lay on the drain base - liner needs to lay directly on base.

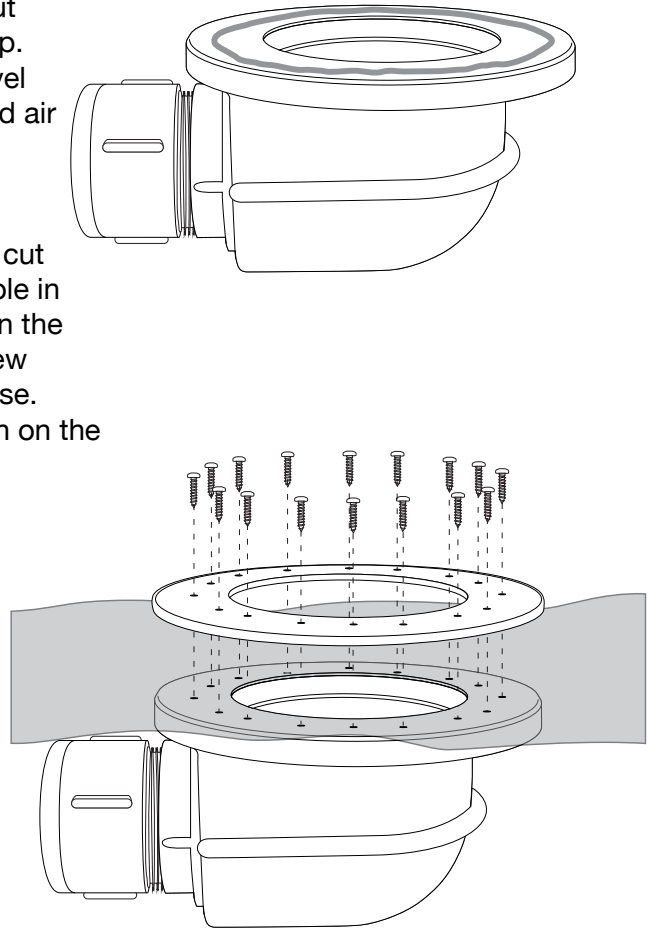

3 Be sure liner is laying flat (no wrinkles) on drain base. Place mounting ring on liner and center with drain base. There are 16 small indentations on one side of the ring — be sure the indentations face up. Using the screws provided carefully screw mounting ring to drain base. **If using a cordless drill be careful not to over-tighten screws!** Ideally a cordless drill is used to start the screw. But to tighten them, a hand screw driver gives you a better feel when screws are tight.

4 Thread the PVC stand pipe into the base making sure that the blue check valve is on the bottom near the base. Verify the arrow on the check valve is pointed up.

5 Thread the lid on to the upward end of the stand pipe (no teflon needed). Finish by threading the air diffuser onto the lid. Installation of the EBD4A is now complete.

